

# KG Series Industrial Ventilator

## KG Series Industrial Ventilator Introduction



KG series ventilators are updated models of the fans in the market that have been redesigned and upgraded with the aim of reducing energy consumption and increasing efficiency and reducing maintenance costs. These ventilators are produced in three sizes 120 ,100 and 140 and can be used for proper ventilation of industrial environments, poultry farms and greenhouses

# KG Series Industrial Ventilator

## KG Series Industrial Ventilator Structure and Advantages

- Other key parts in the power transmission section, such as shafts, pulleys, and bearings, have high strength, which, along with the precise design of the device, guarantees the quality and strength.
- Hot galvanized body with high thickness and double chassis increase the strength of the body.
- The aerodynamic design of the blades with special metal housing increases the air output of the fan.
- Hinged mesh doors for protection and access to internal parts in the shortest possible time
- KG fan has centrifugal damper and belt tensioner.
- Specific handles for easy transportation.
- 4 international standard marks and European Union CE certification.



# KG Series Industrial Ventilator

## KG Series Industrial Ventilator Control

Features	Unit	140	120	100
Power supply	Ph/V/Hz	3*380/50	3*380/50	3*380/50
Net weight	Kg	126	100	75
Dimensions (height, width, length)	cm	141*55*141	121*54*121	98*56*98
Suction power	CFM	26000	21000	13000
Suction power	m <sup>2</sup> /h	46000	36000	23000
Electric motor	HP	2	1.5	1
Fan speed	rpm	459	525	700

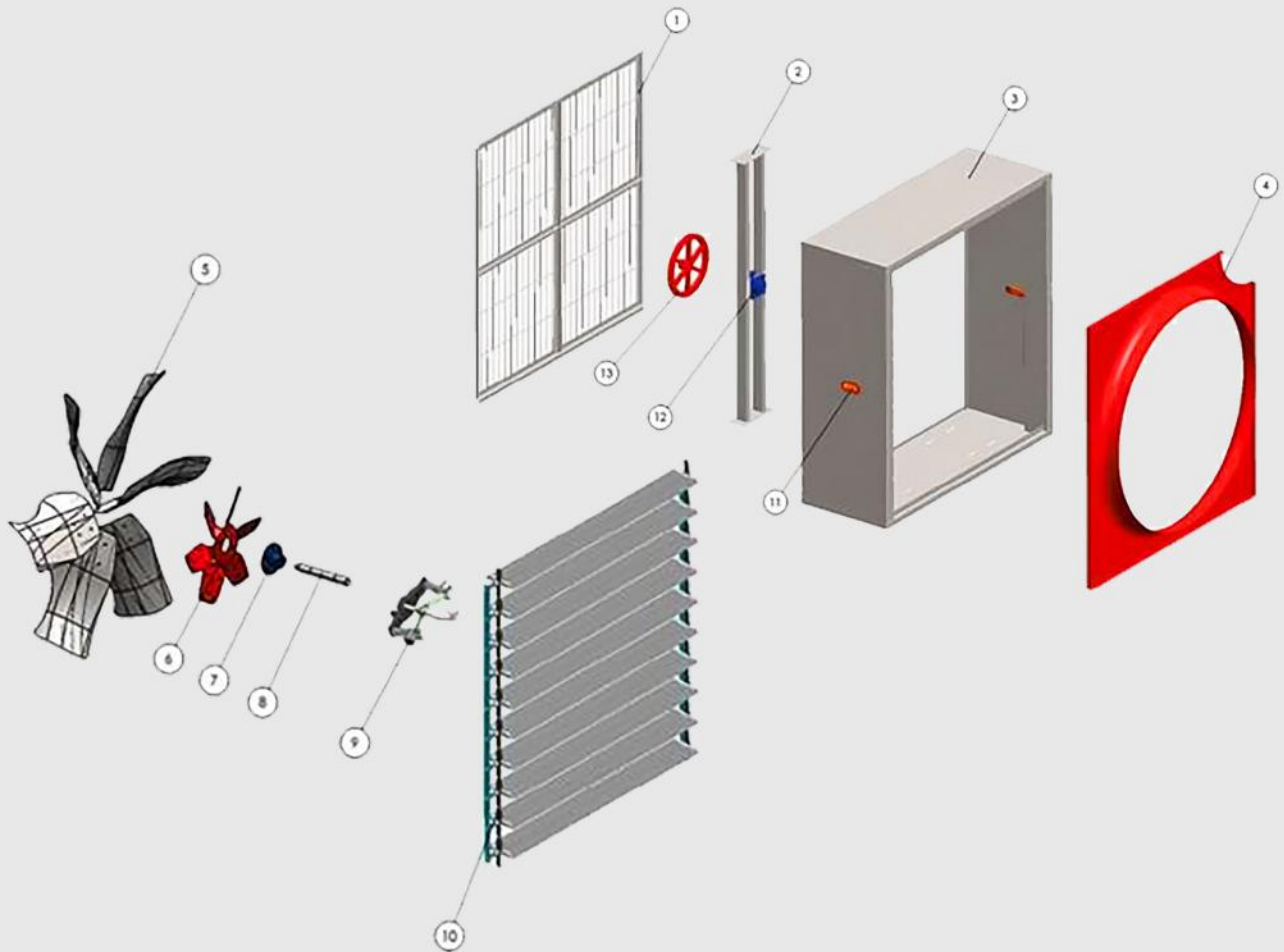

# KG Series Industrial Ventilator

## KGY Exhaust Fan Accessories



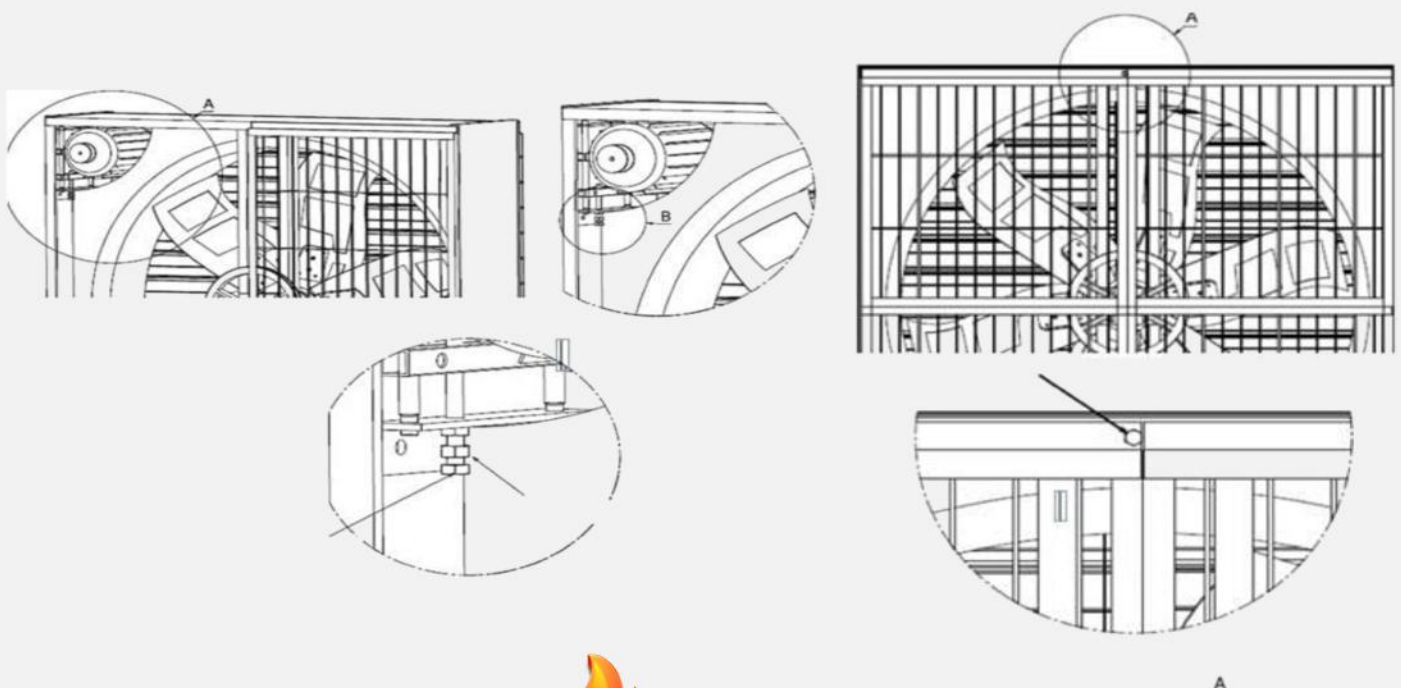

Number	Component Name	Material
1	Mesh	wire/galvanized
2	Support base	oily steel
3	Body	galvanized
4	Hosing	oily steel
5	Fan Blade	galvanized
6	Sun-like	oily steel
7	Navel-like	cast iron
8	Shaft	CK45
9	Damper Clutch	ABS
10	Damper	galvanized
11	Handle	ABS
12	Bearing	galvanized
13	Fan Pulley	Aluminum / Cast Iron



# KG Series Industrial Ventilator

## KG Series Industrial Ventilator Control

KG series industrial ventilators can be connected to the electrical and automation control panel and in this way adjust the pressure and temperature and balance the different gases in the hall.

<p><b>Propeller:</b> The propeller is made with KGY exclusive design made of high-quality galvanized alloy with specialized dynamic balance 6 mm solar to move the air with the least noise and maximum pressure.</p>	
<p><b>Body:</b> Solid fully galvanized body made by CNC cutting, punching and bending devices with the highest precision and the lowest amount of vibration</p>	
<p><b>Automatic clutch damper:</b> Automatic clutch dampers have been used in model 140 and 120 fans. Easy opening and closing, minimal friction with exhaust air, preventing hot air leakage outside the hall when the fan is off, and preventing dust and vermin from entering the hall when the fan is off is some of the most important advantages of using automatic dampers.</p>	
<p><b>Electromotor:</b> The torque required to turn the propeller by a three-phase electric motor is supplied with alternating current. The design of the location of the electric motor in the device is such that it does not increase the width of the device, and the distance between the fan axis and the electric motor allows the use of a long belt, which keeps the belt cool while operating.</p>	
<p><b>Shaft and bearing:</b> The material of the shaft is 45CK anti-wear steel, which in addition to its high strength, does not change shape or vibrate due to continuous work. The usage of two high-quality UCF bearings guarantees the smooth and silent movement of the shaft and maintenance of the balance of the fan.</p>	